



if it flows,
we go with it

1.800.665.4499
barrplastics.com

© DEN HARTOG INDUSTRIES, INC.

Copyright. All information furnished within this document, electronic file or design correspondence is the property of Den Hartog industries, Inc. and shall not be used, disclosed to others or copied without the expressed written consent of Den Hartog Industries, Inc.

OP6800-120

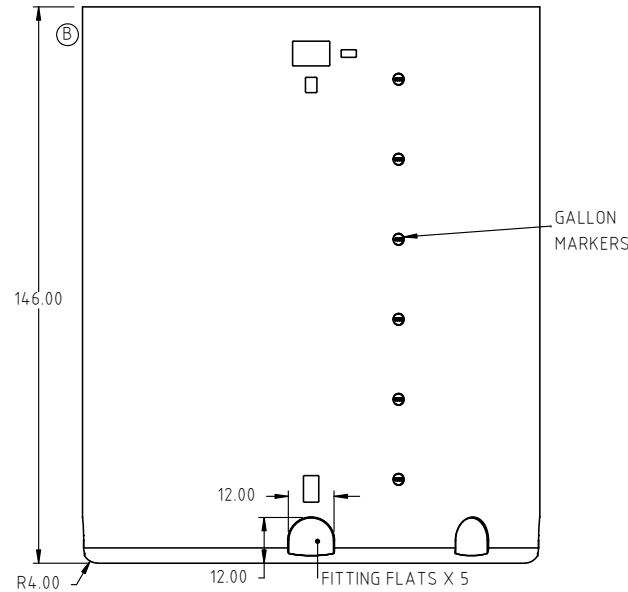
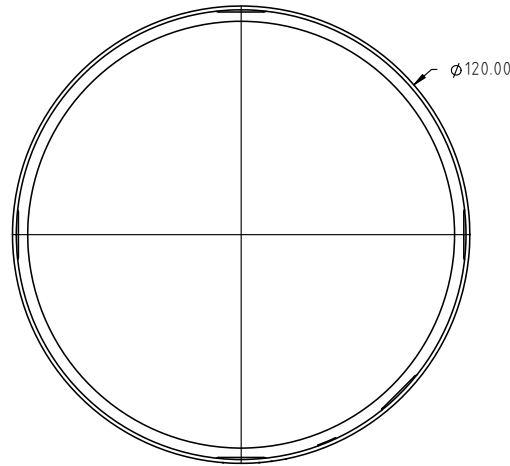

				DRAWN / DATE DHJ 5/22/08	MATERIAL HDPE OR EQUIVALENT REFERENCE MATERIAL DATA SHEET FOR SPECIFIC PROPERTIES
B	RIB FEATURE REMOVED. BOLT ON LID NO LONGER AN OPTION	ADH 1/7/19	3694	APPRD. / DATE REH 6/12/08	NOTES: 1.) 1.00 THICK AT FLATS
REV	DESCRIPTION	BY / DATE	CCN	SHOT WEIGHT: 1900 LBS SHIPPING WEIGHT: 1525 LBS FINISH:	
ALL DIMENSIONS ARE IN DECIMAL INCHES TOLERANCES UNLESS OTHERWISE SPECIFIED		THIRD ANGLE PROJECTION ANSI 14.5M			
POLYETHYLENE ±1% @ 68° F		METAL DECIMAL ± .125" FRACTION ± 1/4" ANGLE ± 1°			



Den Hartog
INDUSTRIES, INC.

Ace Roto-Mold Injection Molding Blow Molding Sowjoy
4010 HOSPERS DRIVE S. BOX 425, HOSPERS, IOWA 51238-0425

DESCRIPTION 6800 GALLON OPEN TOP	
SCALE N.S.	PART NO. OP6800-120